

CONSTRUCTION NOTICE REQUIREMENT

To protect operational safety and future development, all proposed construction on the airport must be coordinated by the airport owner with the FAA Airports District Office prior to construction. FAA's review takes approximately 60 days.

SEE TERMINAL AREA DRAWING FOR DETAILS IN THIS AREA

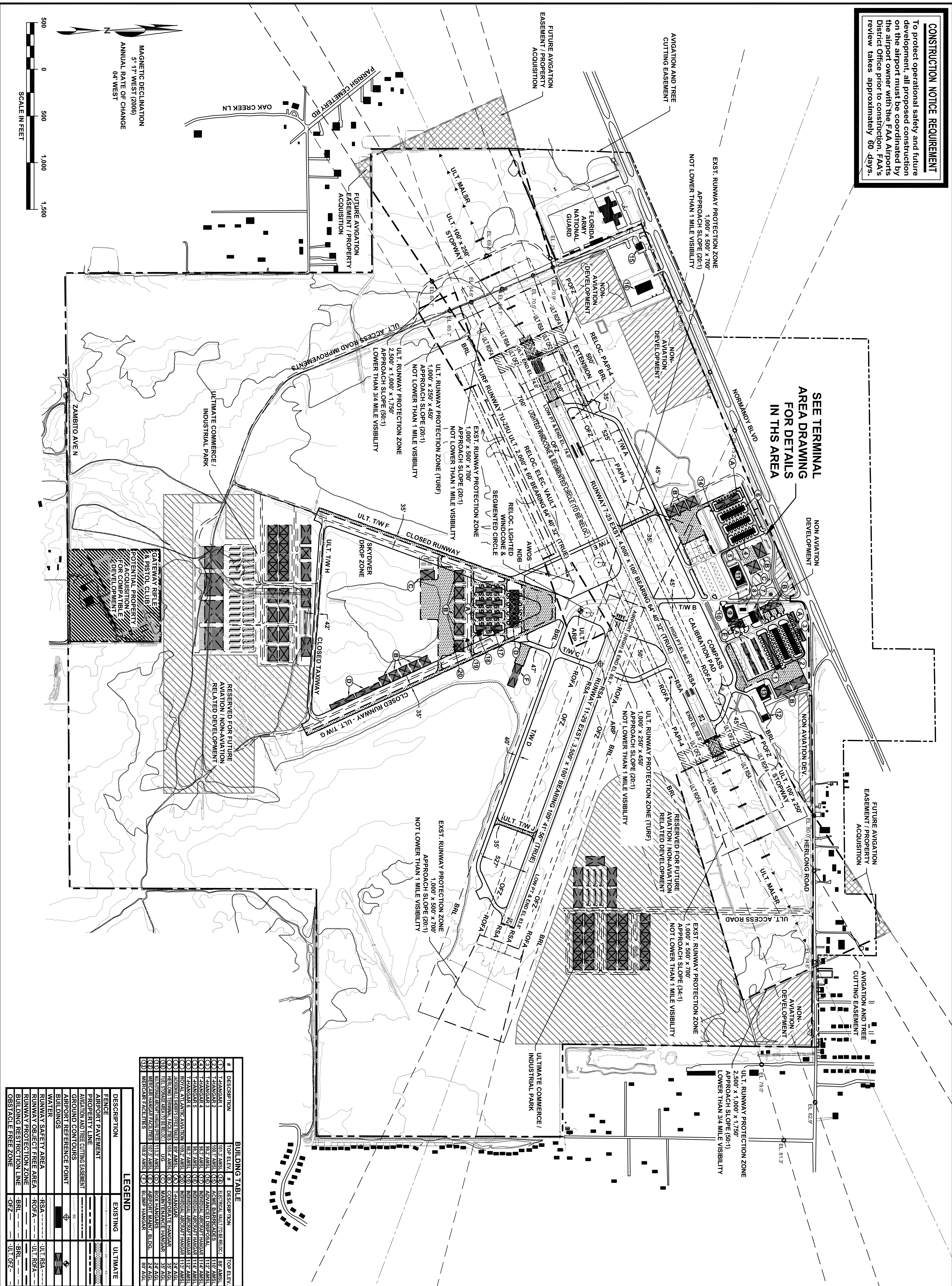

MAGNETIC DECLINATION
5°-17' WEST (2008)
ANNUAL RATE OF CHANGE
0.4' WEST

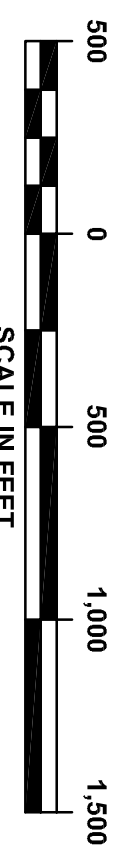

#	DESCRIPTION	TOP ELEV.	#	DESCRIPTION	TOP ELEV.
1	HANGAR 1	100.3 AMSL	10	ELECTRICAL WALK TO BE RELOC.	88' AMSL
2	HANGAR 2	100.7 AMSL	11	AGME BARRICADES	110' AMSL
3	HANGAR 3	98.3 AMSL	12	ADJACENT TO TAXIWAY	112' AMSL
4	HANGAR 4	98.3 AMSL	13	ADJACENT TO TAXIWAY	114' AMSL
5	HANGAR 5	98.3 AMSL	14	ADJACENT TO TAXIWAY	116' AMSL
6	HANGAR 6	98.3 AMSL	15	ADJACENT TO TAXIWAY	118' AMSL
7	ROYAL ATLANTIC AVIATION	102.2 AMSL	16	NONAVIATION AIRCRAFT HANGAR	113' AMSL
8	ROYAL ATLANTIC AVIATION	102.2 AMSL	17	NONAVIATION AIRCRAFT HANGAR	113' AMSL
9	HERLONG TERMINAL FACILITIES	106.4 AMSL	18	CORPORATE HANGAR	57' AGS
10	HERLONG TERMINAL FACILITIES	106.4 AMSL	19	MAINTENANCE HANGAR	57' AGS
11	HERLONG TERMINAL FACILITIES	106.4 AMSL	20	MAINTENANCE HANGAR	57' AGS
12	HERLONG TERMINAL FACILITIES	106.4 AMSL	21	MAINTENANCE HANGAR	57' AGS
13	HERLONG TERMINAL FACILITIES	106.4 AMSL	22	MAINTENANCE HANGAR	57' AGS
14	HERLONG TERMINAL FACILITIES	106.4 AMSL	23	MAINTENANCE HANGAR	57' AGS
15	HERLONG TERMINAL FACILITIES	106.4 AMSL	24	MAINTENANCE HANGAR	57' AGS
16	HERLONG TERMINAL FACILITIES	106.4 AMSL	25	MAINTENANCE HANGAR	57' AGS
17	HERLONG TERMINAL FACILITIES	106.4 AMSL	26	MAINTENANCE HANGAR	57' AGS
18	HERLONG TERMINAL FACILITIES	106.4 AMSL	27	MAINTENANCE HANGAR	57' AGS
19	HERLONG TERMINAL FACILITIES	106.4 AMSL	28	MAINTENANCE HANGAR	57' AGS
20	HERLONG TERMINAL FACILITIES	106.4 AMSL	29	MAINTENANCE HANGAR	57' AGS
21	HERLONG TERMINAL FACILITIES	106.4 AMSL	30	MAINTENANCE HANGAR	57' AGS

LEGEND

DESCRIPTION	EXISTING	ULTIMATE
FENCE	[Symbol]	[Symbol]
AIRPORT PAVEMENT	[Symbol]	[Symbol]
PROPERTY LINE	[Symbol]	[Symbol]
AVIATION AND TREE CUTTING EASEMENT	[Symbol]	[Symbol]
AIRPORT REFERENCE POINT	[Symbol]	[Symbol]
BUILDINGS	[Symbol]	[Symbol]
WATER	[Symbol]	[Symbol]
RUNWAY SAFETY AREA	[Symbol]	[Symbol]
RUNWAY OBJECT FREE AREA	[Symbol]	[Symbol]
RUNWAY PROTECTION ZONE	[Symbol]	[Symbol]
BUILDING RESTRICTION LINE	[Symbol]	[Symbol]
OBSTACLE FREE ZONE	[Symbol]	[Symbol]

JACKSONVILLE AVIATION AUTHORITY
HERLONG AIRPORT
JACKSONVILLE, FLORIDA

THE LPA GROUP
TRANSPORTATION CONSULTANTS

ATLANTA, GA · BATON ROUGE, LA · CHARLESTON, SC
CHARLOTTE, NC · CHICAGO, IL · COLUMBIA, SC
GREENSBORO, NC · JACKSONVILLE, FL · KNOXVILLE, TN
MOBILE, AL · ORLANDO, FL · RALEIGH, NC · RICHMOND, VA
SASASOTA, TN · TAMPA, FL · WEST PALM BEACH, FL

Designer: _____

TGM: _____

Technical: _____

TGM: _____

Checked by: _____

TF: _____

Project Number: _____

PL502022

NOTES

1. ALL EXISTING HOLDING POSITION MARKINGS FOR RUNWAY CENTERLINE AND PERPENDICULAR TO TAXIWAY CENTERLINE AND PERPENDICULAR TO TAXIWAY CENTERLINE FOR RUNWAY/TAXIWAY INTERSECTIONS ARE 125' FROM RUNWAY CENTERLINE AND PERPENDICULAR TO TAXIWAY CENTERLINE.
2. COORDINATES SHOWN HEREON ARE IN NAD83.
3. ELEVATIONS SHOWN HEREON ARE IN NAVD83 AND ARE ABOVE MEAN SEA LEVEL (AMSL).
4. SEE AIRPORT PROPERTY MAP FOR PROPERTY LINE METERS AND BOUNDS.
5. NO OFZ OBJECT PENETRATIONS.
6. NO THRESHOLD STING PENETRATIONS.
7. THE ARROWHEADS PRECEDING RUNWAY 11 AND RUNWAY 14 INTERSECTIONS ARE 125' FROM RUNWAY CENTERLINE AND PERPENDICULAR TO TAXIWAY CENTERLINE. ALL ULTIMATE HOLDING POSITION MARKINGS FOR RUNWAY/TAXIWAY INTERSECTIONS ARE 125' FROM RUNWAY CENTERLINE AND PERPENDICULAR TO TAXIWAY CENTERLINE.
8. SEE DRAWING 8, AIRPORT PROPERTY MAP, FOR COMPLETE AIRPORT PROPERTY EASEMENT, AND RUNWAY PROTECTION ZONE BOUNDARIES.
9. THE BRL IS DETERMINED BY THE TAXIWAY OFA FOR THE PARALLEL TAXIWAYS AND THE CLEARANCE OF A 20 FOOT TALL OBJECT ON THE OPPOSITE SIDE.

No.	Description	Date	By

Project Name: **MASTER PLAN UPDATE**

Drawing Name: **AIRPORT LAYOUT DRAWING**

FAA A.L.P. Project Number: _____

Autocad Drawing Reference: _____

Date: **MARCH 2008**

Division: **PLANNING**

Scale: **1" = 500'**

Drawing Number: **2**