

PLAN VIEW (RUNWAY 7)

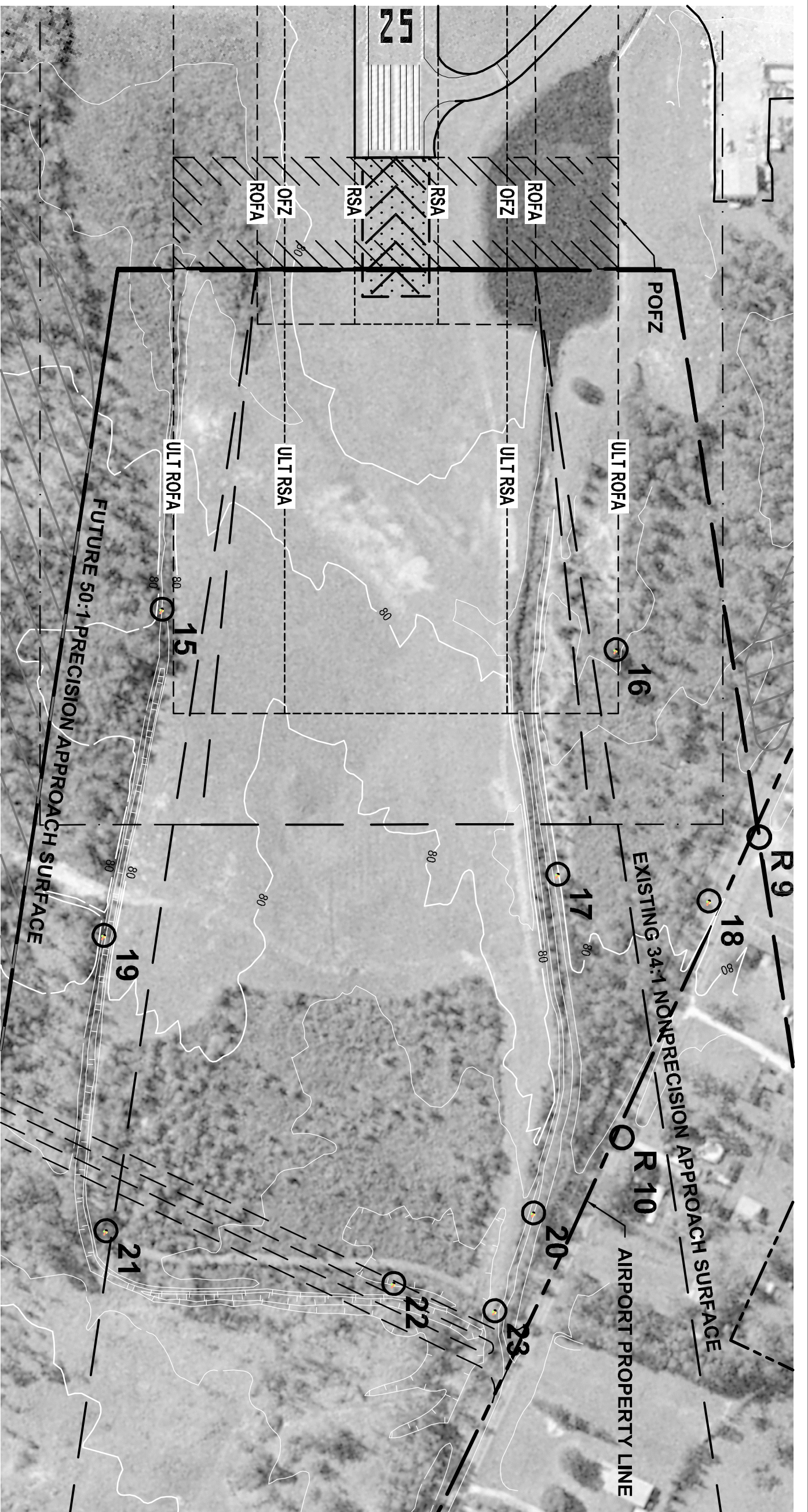

PLAN VIEW (RUNWAY 25)

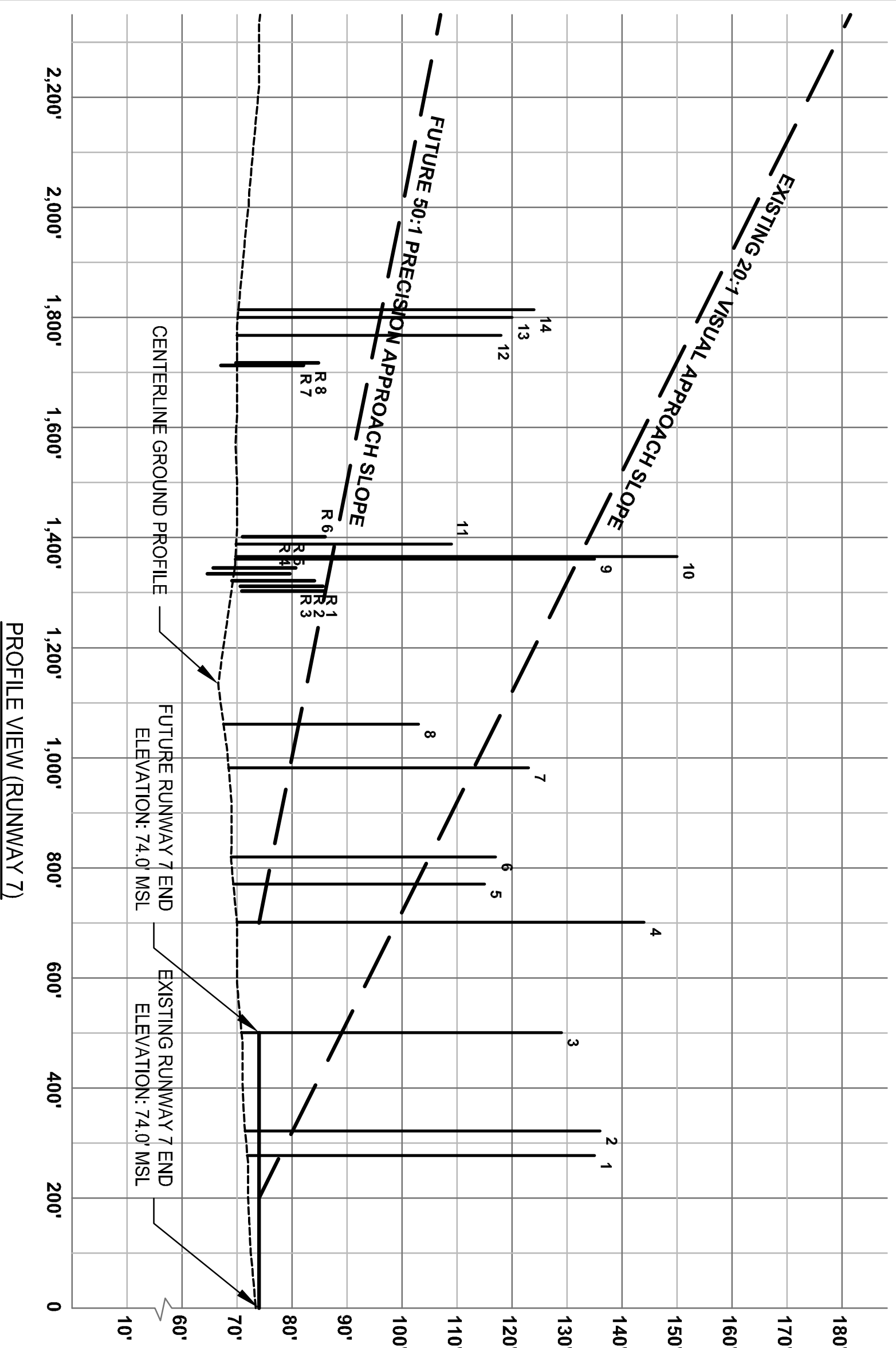

PROFILE VIEW (RUNWAY 7)

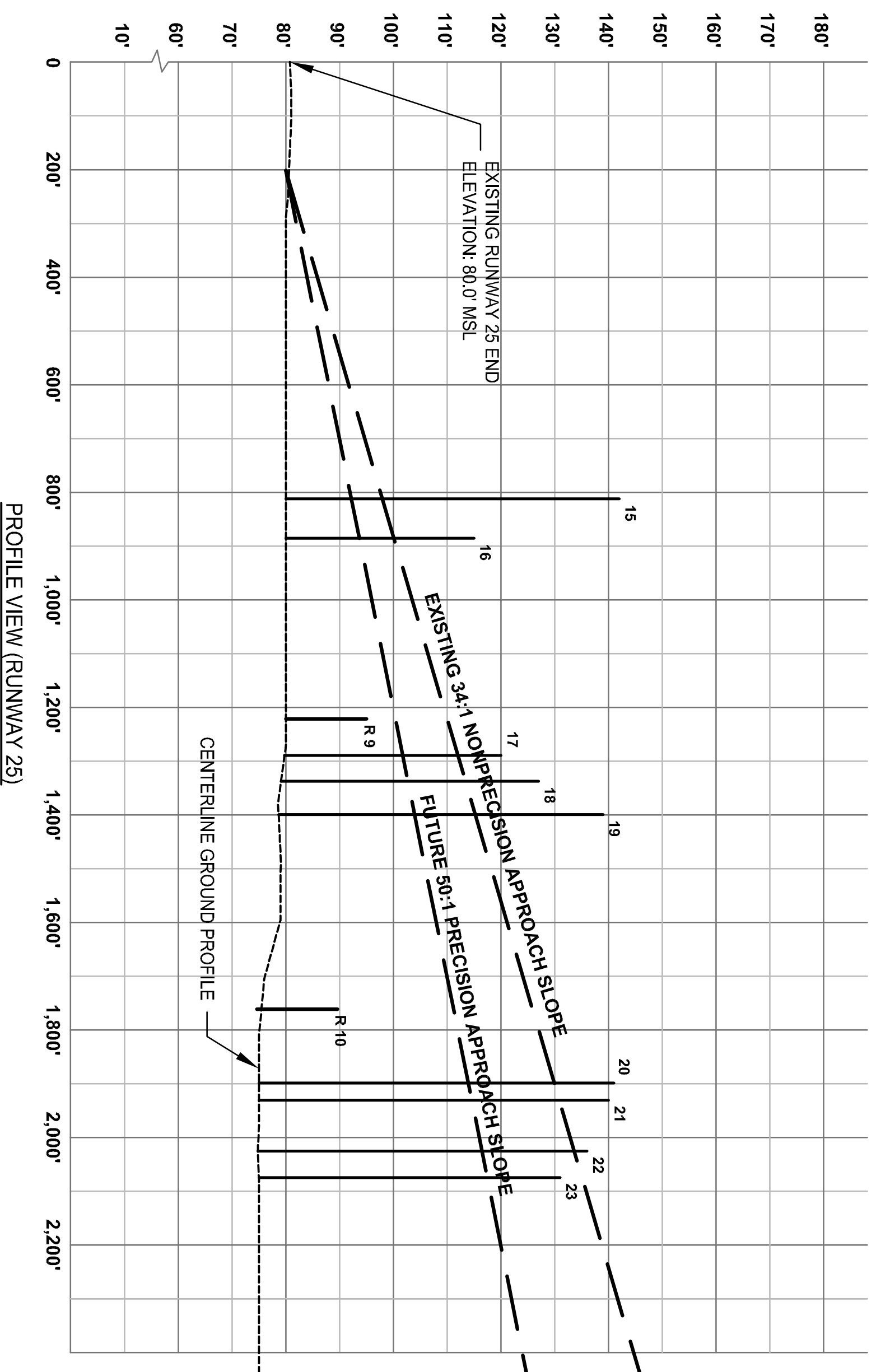

PROFILE VIEW (RUNWAY 25)

#	TYPE	OBSTRUCTION ALLOWABLE ELEVATION	EXISTING PART 77 PENETRATION	EXISTING PART 77 ELEV.	FUTURE ALLOWABLE PENETRATION	FUTURE PART 77 ELEV.	DISPOSITION
1	TREE	135.0	116.4	18.6	78.4	56.6	TRIM / REMOVE
2	TREE	136.0	125.2	10.8	81.6	54.4	TRIM / REMOVE
3	TREE	144.0	130.7	13.3	74.1	69.9	TRIM / REMOVE
4	TREE	144.0	130.7	13.3	74.1	69.9	TRIM / REMOVE
5	TREE	115.0	118.7	-3.7	75.4	39.6	TRIM / REMOVE
6	TREE	117.0	122.4	-5.4	76.4	40.6	TRIM / REMOVE
7	TREE	123.0	120.1	2.9	79.7	43.3	TRIM / REMOVE
8	TREE	103.0	146.9	-43.9	81.3	21.7	TRIM / REMOVE
9	TREE	135.0	132.1	2.9	87.3	47.7	TRIM / REMOVE
10	TREE	150.0	153.6	-3.6	87.8	62.2	TRIM / REMOVE
11	TREE	109.0	133.5	-24.5	95.4	22.6	TRIM / REMOVE
12	TREE	118.0	152.5	-34.5	95.4	22.6	TRIM / REMOVE
13	TREE	120.0	154.1	-34.1	96.0	24.0	TRIM / REMOVE
14	TREE	120.0	154.5	-34.5	96.3	24.3	TRIM / REMOVE
R 1	ROAD	85.0	139.2	-54.2	85.0	85.0	NO ACTION
R 2	ROAD	84.1	139.1	-55.0	85.2	85.2	NO ACTION
R 3	ROAD	79.6	130.6	-51.0	86.4	86.4	NO ACTION
R 4	ROAD	80.7	166.3	-85.6	86.9	86.9	NO ACTION
R 5	ROAD	86.0	N/A	N/A	88.0	88.0	NO ACTION
R 6	ULT ROAD	82.1	N/A	N/A	94.3	-12.2	NO ACTION
R 7	ULT ROAD	84.8	N/A	N/A	94.4	-9.6	NO ACTION
R 8	ULT ROAD	84.8	N/A	N/A	94.4	-9.6	NO ACTION

DESCRIPTION	EXISTING	ULTIMATE
DESIGNATION	---	---
FENCE	---	---
AIRPORT PAVEMENT	---	---
PROPERTY LINE	---	---
AIRPORT AND TREE CUTTING EASEMENT	---	---
GROUND CONTOURS	---	---
AIRPORT REFERENCE POINT	---	---
BUILDINGS	---	---
WATER	---	---
RAILROAD	---	---
UTILITY	---	---
OBSTACLE FREE ZONE	---	---

#	TYPE	OBSTRUCTION ALLOWABLE ELEVATION	EXISTING PART 77 PENETRATION	EXISTING PART 77 ELEV.	FUTURE ALLOWABLE PENETRATION	FUTURE PART 77 ELEV.	DISPOSITION
15	TREE	142.0	109.1	32.9	92.2	49.8	TRIM / REMOVE
16	TREE	115.0	106.4	8.6	93.6	21.4	TRIM / REMOVE
17	TREE	120.0	112.0	8.0	101.7	18.3	TRIM / REMOVE
18	TREE	127.0	133.9	-6.9	102.7	24.3	TRIM / REMOVE
19	TREE	139.0	128.7	10.3	103.9	35.1	TRIM / REMOVE
20	TREE	141.0	129.9	11.1	113.9	27.1	TRIM / REMOVE
21	TREE	140.0	132.4	7.6	114.6	25.5	TRIM / REMOVE
22	TREE	136.0	133.6	2.4	116.5	19.6	TRIM / REMOVE
23	TREE	131.0	135.0	-4.0	117.4	13.6	TRIM / REMOVE
R 9	ROAD	95.0	145.8	-50.8	100.5	-5.5	NO ACTION
R 10	ROAD	89.6	129.9	-40.3	111.2	-21.6	NO ACTION

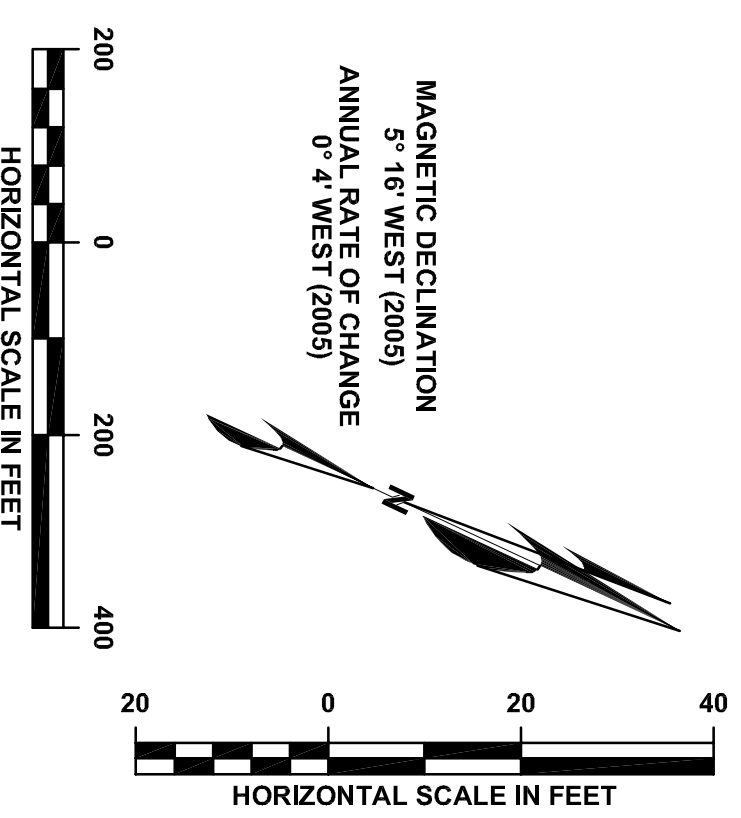

**JACKSONVILLE**  
AVIATION AUTHORITY  
HERLONG AIRPORT  
JACKSONVILLE, FLORIDA

**THE LPA GROUP**  
TRANSPORTATION CONSULTANTS

ATLANTA, GA - BAYTON SQUARE, LA - CHARLESTON, SC  
CHARLOTTE, NC - CHICAGO, IL - COLUMBIA, SC  
GREENSBORO, NC - JACKSONVILLE, FL - KNOXVILLE, TN  
MOBILE, AL - ORLANDO, FL - RALEIGH, NC - RICHMOND, VA  
SASASOTA, TN - TALLAHASSEE, FL - TAMPA, FL - WEST PALM BEACH, FL

Designer: \_\_\_\_\_  
TGM: \_\_\_\_\_  
Technician: \_\_\_\_\_  
Checked by: \_\_\_\_\_  
TF: \_\_\_\_\_  
Project Number: \_\_\_\_\_  
PL502022

- NOTES**
- ELEVATIONS SHOWN ARE REFERENCED TO THE MADS8 AND DISPLAYED IN FEET ABOVE MEAN SEA LEVEL (AMSL). HEIGHT ABOVE THE SLOPE AS INDICATED IN TABLES ARE DISPLAYED IN FEET AS CALCULATED ABOVE THE THRESHOLD HEIGHT AND ARE ONLY APPROXIMATE.
  - HORIZONTAL COORDINATES ARE IN MADS83.
  - OBSTACLE LOCATIONS AND THEIR RESPECTIVE ELEVATIONS WERE OBTAINED FROM A SURVEY PERFORMED BY L.D. BRADLEY LAND SURVEYORS, DATED FEBRUARY 23, 2006.
  - BRL SHOWN IS FOR A TYPICAL 25 FOOT BUILDING.
  - ROAD ELEVATIONS ARE ADJUSTED 15' UPWARD TO ACCOMMODATE MOBILE OBJECTS THAT WOULD NORMALLY TRAVERSE THE ROAD.

No.	Description	Date	By

Project Name: **MASTER PLAN UPDATE**

Drawing Name: **INNER PORTION OF THE RUNWAY 7/25 APPROACH SURFACE DRAWING**

Anticipated Drawing Reference: \_\_\_\_\_  
Date: **MARCH 2008**  
Scale: **HORIZONTAL: 1" = 200'**  
**VERTICAL: 1" = 20'**

Division: **PLANNING**  
Drawing Number: **5**